

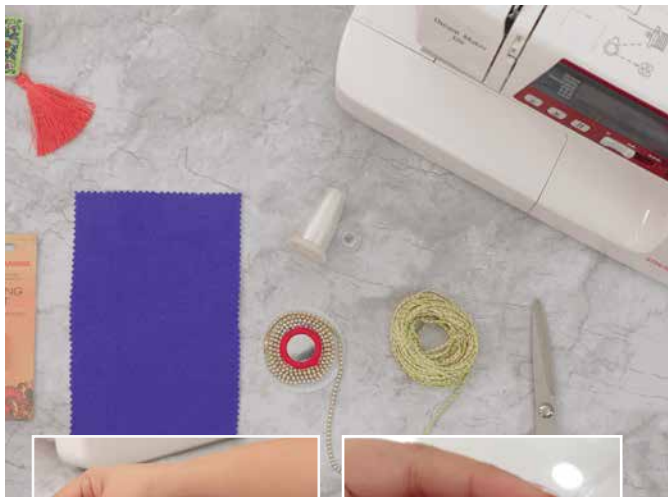

In this video, you will learn how to embellish with bead strings using the Usha Janome Beading Foot.



How often have you seen garments or accessories embellished with beads and yearned to do the same, but without the pain of attaching one bead at a time? Here is your answer. In this video, you will learn to do exactly that – embellishing with bead strings using the Usha Janome Beading Foot.

The Usha Janome Beading foot will help you sew on beads of all kinds – wooden, glass, pearl, as long as the bead size is between 2.5mm and 4.0 mm. Curious to explore how it can be so simple...let's get started.

For this lesson you will need the Usha Janome Beading Foot, a piece of cloth to practice the beading on, beaded lace, cord (diameter of beads between 2.5 to 4 mm), transparent thread and a pair of scissors.

Place the bead lace strip across the piece of cloth, and cut to measure.

Use the beading foot, which has two attachment .

Replace your normal presser foot with the beading foot by snapping it on.

Place the line of beads under the groove of the

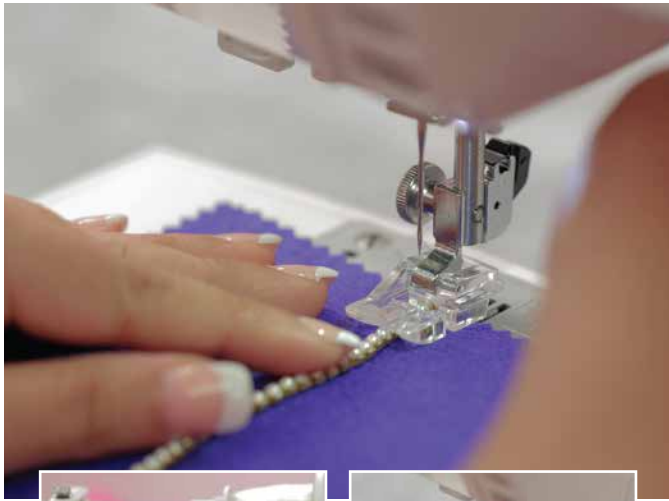

beading foot like this.

Select the Zigzag Stitch, adjust stitch width to 4, and stitch length to 2.5.

Press start, keep the speed slow, and begin stitching along the straight line of beads. You will see how the needle goes in a crisscross fashion to secure the beads onto the fabric. Once you reach the end, cut the thread and survey the result of your first piece of beaded sample – aren't you happy! Am sure you are now eager to get your hands on to all those projects you have been dying to add beads to. See this necklace made with beads – isn't it stunning!

You can also use cord instead of thread for an added design element like. Once you explore the market for various types of cords and beads, you will realize what you can do with this foot. You can also use this foot attachment to stitch beads as well as cords on the fabric or any material of your choice as it can be used on paper, plastic and even jute.